



HOW TO CHECK SCHEDULES & GRADES?

1

LOG INTO LAUNCHPAD

Go to Launchpad.ocps.net

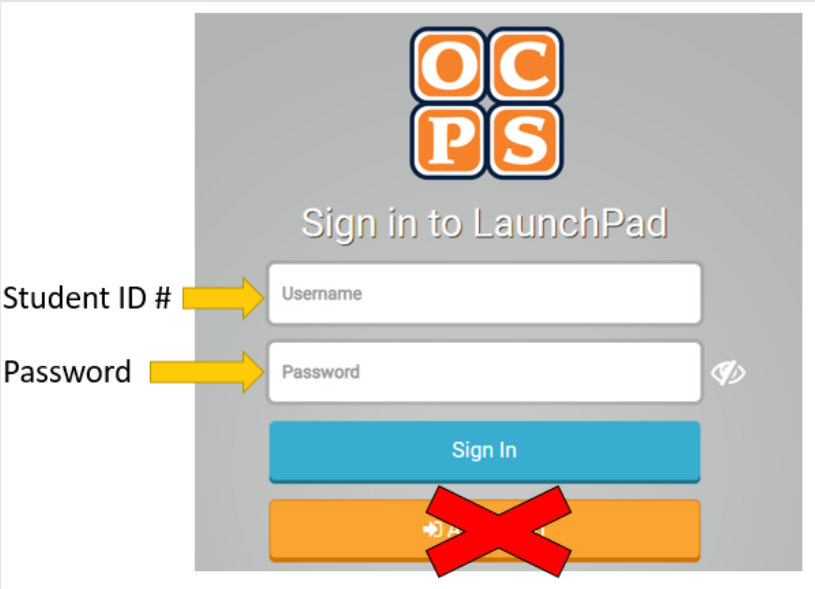

2

SELECT THE SKYWARD APP

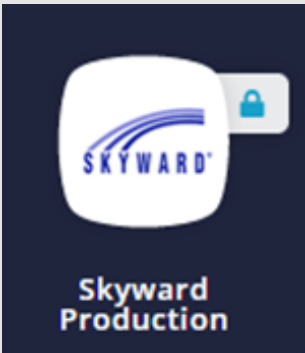

A

SCHEDULES SELECT 'SCHEDULE' FROM LIST

Student schedule will appear. Write down on paper with correspondning BELL SCHEDULE.

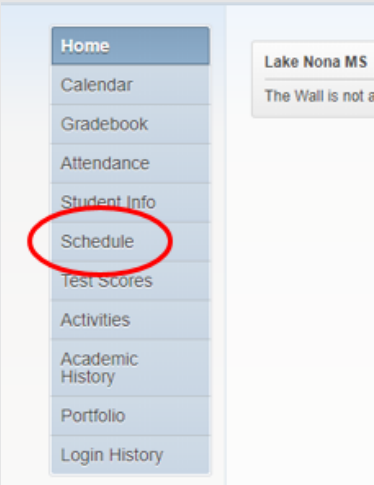

B

GRADEBOOK SELECT 'GRADEBOOK' FROM LIST

Students will see a list of their classes with their grade. If they have missing assignments, it will show up at the top. If they want to see a list of assignments, the student needs to select the ▶

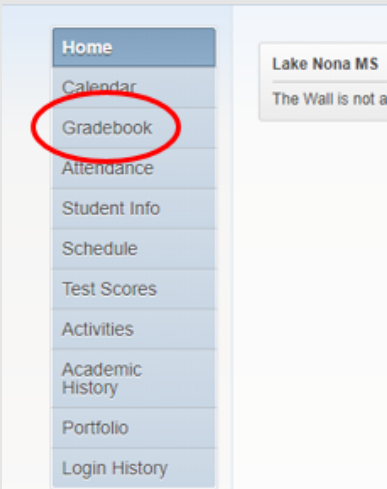

Missing Assignments

List of Assignments

Home

Calendar

Gradebook

Attendance

Student Info

Schedule

Test Scores

Activities

Academic History

Portfolio

Login History

Gradebook

There are no Missing Assignments.

Class Grades

Anabel (Lake Nona MS)

Display Options

Class	CP1	PR1	CR1	RC1
M/J Instrumental Ensemble 1 Period 1 (9:30 AM - 10:17 AM) Hannah Jennings				
M/J United States History Advanced & Career Planning Period 2 (10:25 AM - 11:12 AM) Beatriz Molina				
M/J Band 4 Period 3 (11:16 AM - 12:03 PM) Hannah Jennings				
M/J Individual/Dual Sports - Grade 8 Period 4C (12:37 PM - 1:24 PM) Irimar Hernandez				
M/J Extreme/Alternative Sports - Grade 8 Period 4C (12:37 PM - 1:24 PM) Irimar Hernandez				
▶ PHYSICAL SCIENCE HONORS Period 5 (1:28 PM - 2:15 PM) Amy Kramer		100		100
▶ Geometry Honors Period 6 (2:19 PM - 3:06 PM) Harley Burghdurf		100		100
▶ M/J Language Arts 3, Advanced Period 7 (3:10 PM - 3:57 PM) David Miller		100		100





HOW TO FIND LIVE LESSONS?

1 LOG INTO LAUNCHPAD

Go to Launchpad.ocps.net

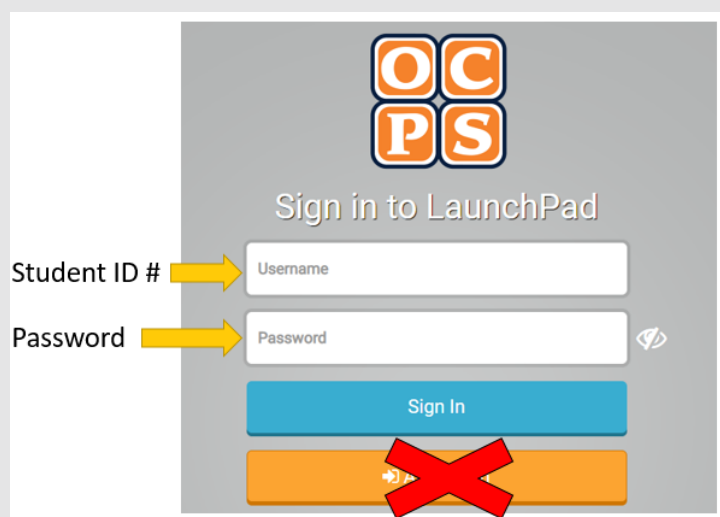

2 SELECT THE COURSE BASED ON BELL SCHEDULE

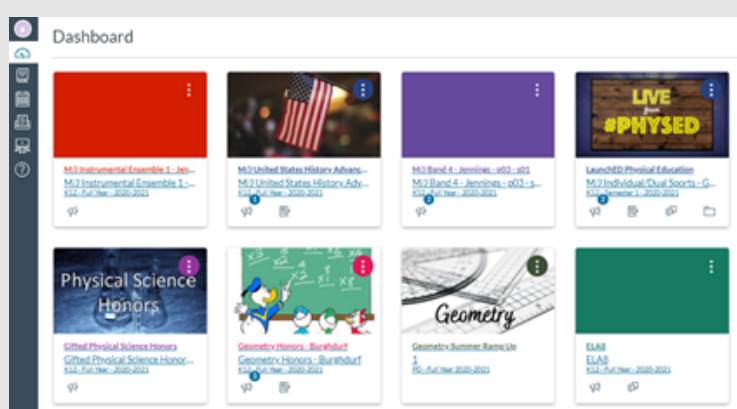

A WHERE TO FIND CONFERENCES/BBB LIVE CLASS MEETING

Teachers will post the link and/or directions on how to join daily live lessons using the Conferences platform under announcements and/or modules. The student may also click on the Conferences tab and select join.

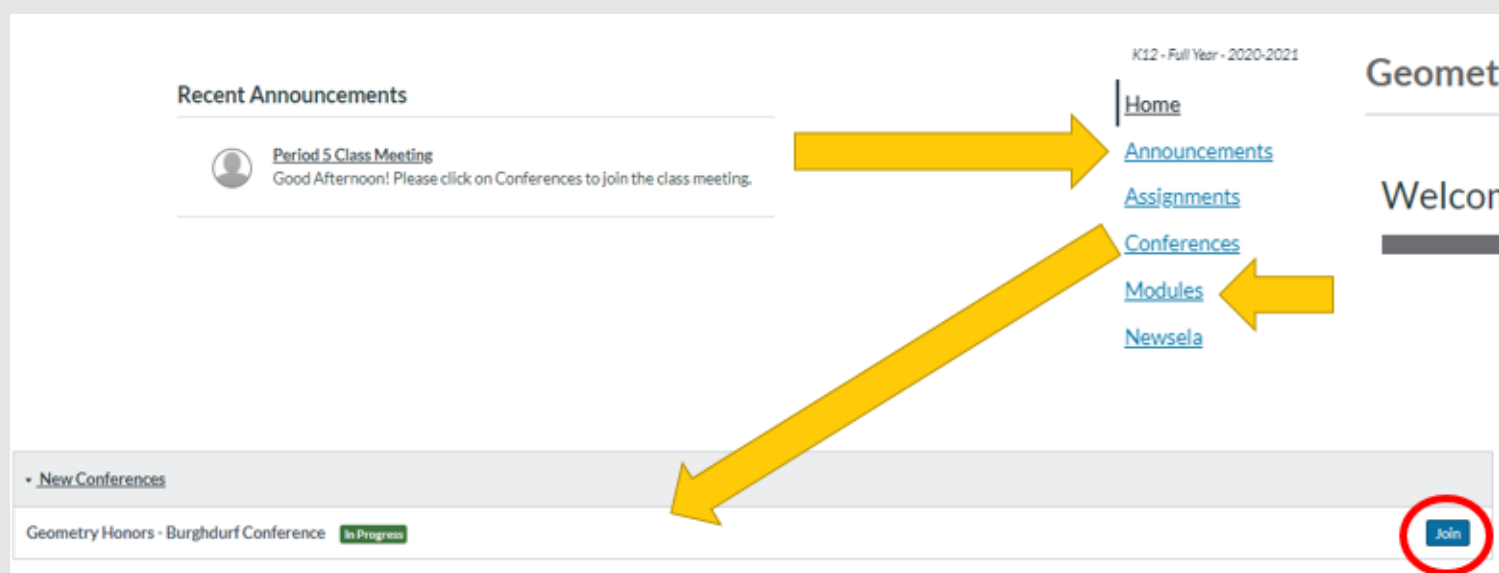

B WHERE TO FIND MICROSOFT TEAMS LIVE CLASS MEETING

Teachers will post the link and/or directions on how to join daily live lessons using Microsoft Teams platform under announcements and/or modules. On the homepage, the student may also see a button that says to join (examples).

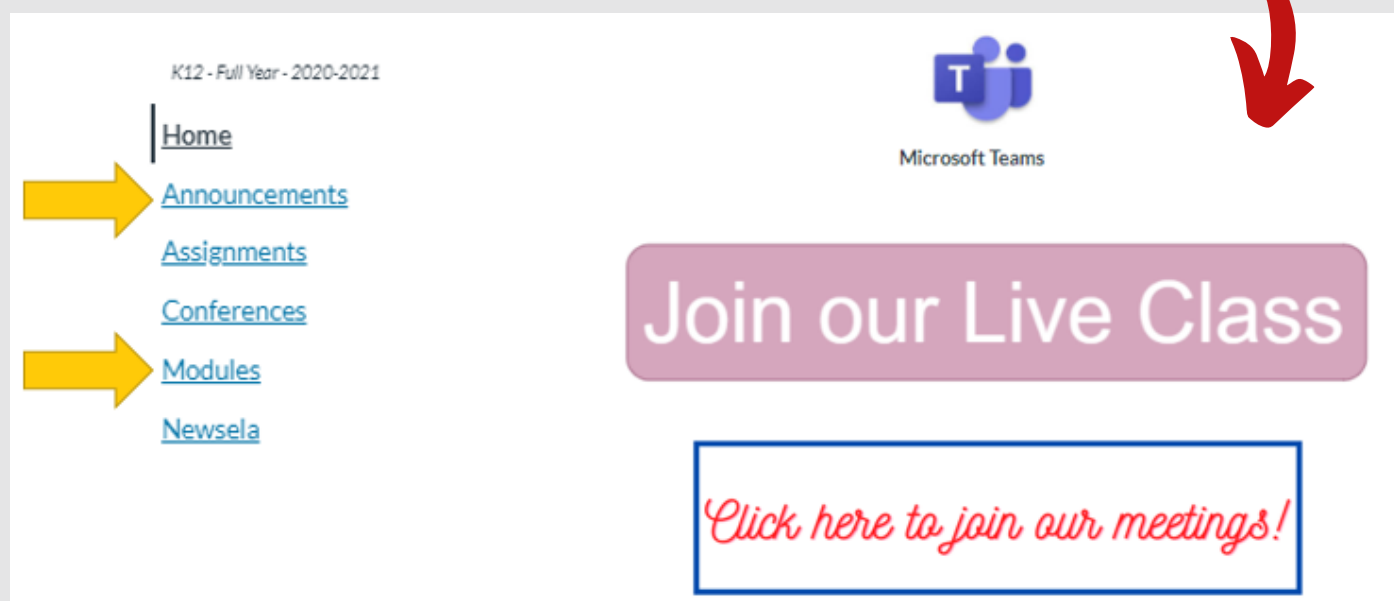

STAY CONNECTED



Students and parents, these are all the ways you can stay connected with Lake Nona MS announcements and events!



JOIN OUR FACEBOOK



@LakeNonaMiddleSchoolOCPS

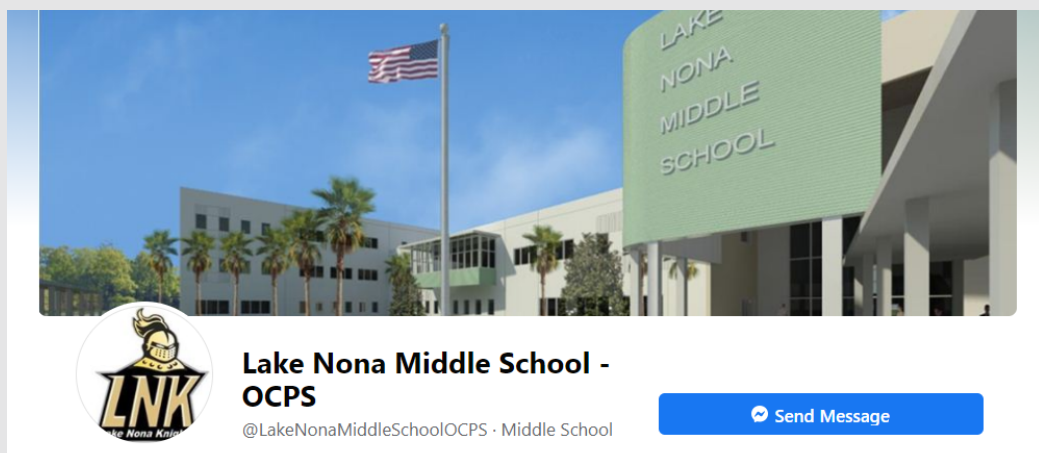

JOIN OUR INSTAGRAM



@lakenonams

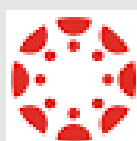

CANVAS

LAKE NONA MS STUDENT BODY PAGE

All students are automatically enrolled in this course. Make sure students are reading Announcements posted on top of the dashboard.

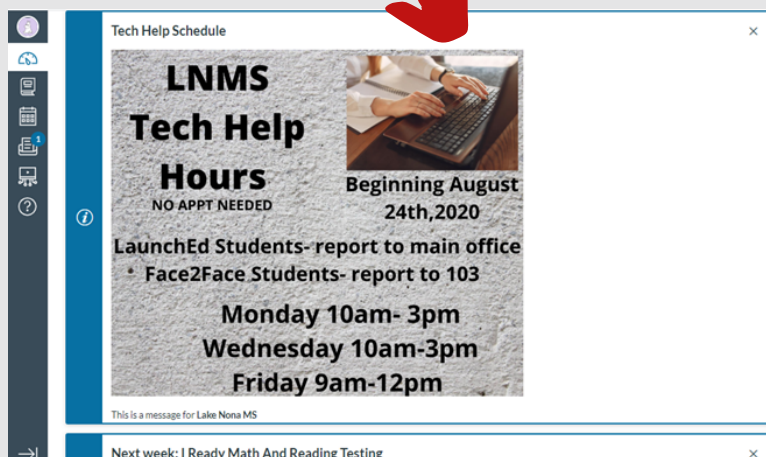
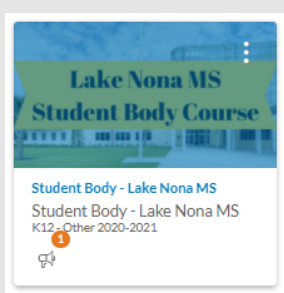

OUR SCHOOL WEBSITE & SIGN UP FOR THE KINGDOM CHRONICLE

Lakenonams.ocps.net

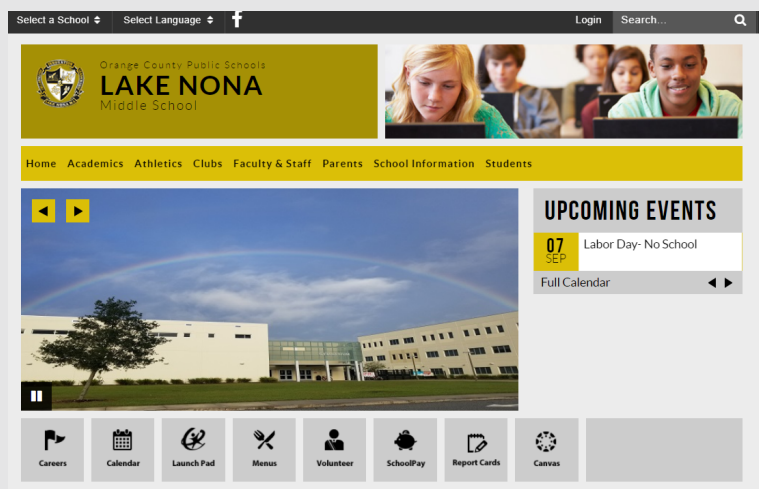

The Kingdom's Chronicle.



LAKE NONA MIDDLE SCHOOL

